

System Requirements

- IBM or compatible PC
- Windows operating system
- Pentium or equivalent processor and above
- One available USB port

OS Support

- Windows 98 SE/ME
- Windows 2000/NT
- Windows XP
- Windows 7
- Windows 8

Introduction

Congratulations on your new purchase of the C-board 830 Standard Compact Keyboard. For your personal enjoyment and safety, we recommend that you read through this manual thoroughly before using this product and keep this manual handy for reference if needed.

1

Contents in this package

The following items are included in the package. Please make sure all items are accounted for as you open the package. If there was any item(s) missing or damaged, please contact the reseller where the product was purchased or our support center for further assistance.

- C-board 830 Standard Compact Keyboard x1
- User's manual x1

Specification

- Dimensions: 397.1 x 163 x 25.3mm
- Weight: 688+/- 20g
- Cable length: 1.5 meters
- Interface: USB only
- Key Number: 104 Keys
(may differ by language)

2

How to Install

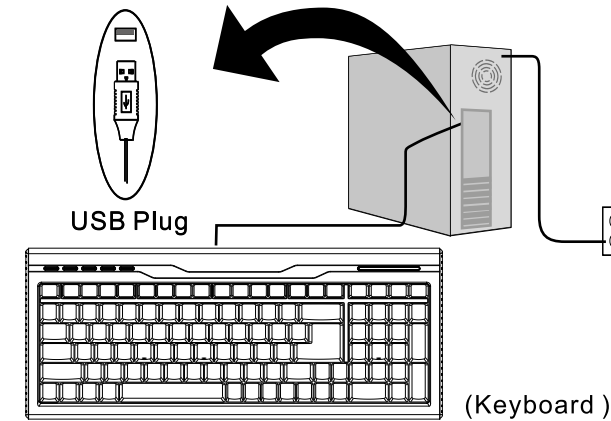

Hot Key Functions

- | | |
|----------------|-------------------------------|
| 🏠 Homepage: | Start the www browser. |
| ✉ E-mail: | Start the e-mail application. |
| 🔊 Volume Up: | Raise the volume. |
| 🔊 Volume Down: | Lower the volume. |
| 🔇 Mute: | Mute the sound. |

3

Ergonomics Compact Keyboard

C-board 830 has an optimized key lay-out, which decreases reach distance to the mouse, 7 cm less wide than a conventional keyboard.

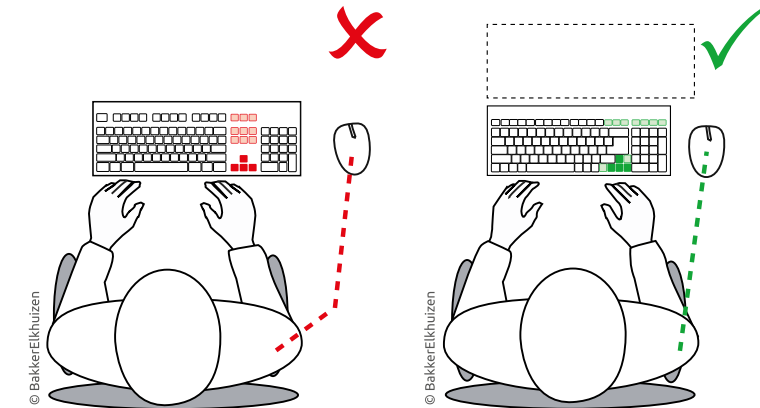

4

Warranty Information

This product is warranted to be free from defects in material and workmanship for a warranty period of 1-YEAR, starting from the date of purchase or maximum of 18 months since the product left the original factory. If a product proves to be defective in material or workmanship during the warranty period, we will repair or replace the product with a like product at our sole option. Replacement product or parts may include remanufactured or refurbished parts or components. This warranty is valid only for the first purchaser with a valid proof of purchase.

The warranty does not cover:

1. Any product with defaced, modified or removed serial number.
2. Damage, deterioration or malfunction resulting from:
 - Accident, misuse, negligence, natural hazards including: fire, water, lightning and/or other acts of nature.
 - Any unauthorized modifications not complying with the standard product or failure to follow instructions supplied with the product.

5

- Repair or attempted repair by unauthorized personnel.
- Shipping damage; please consult with your point of purchase if the product is suspected to have been damaged during shipping.
- Removal or installation of the product.
- Causes external to the product, such as absence of electrical grounding, power fluctuation, failure and/or power spikes.
- Normal wear and tear.
- Any other cause non related to a product defect.

Troubleshooting

Please visit our On-Line FAQ section for help.

FCC Statement on CLASS B

This device complies with part 15 of the fcc rules. Operation is subject to the following two conditions:

- This device may not cause harmful interference and
- This device must accept any interference received, including interference that may cause undesired operation.

6



Call Pacific Ergonomics

Phone: 619-546-0872

E-mail: customerservice@pacificergo.com

Website: www.pacificergo.com



C-Board 830 Compact keyboard

User's Manual