

How to assemble your chair

For more information about our product and services, please visit us at www.sitmatic.com or call (800) 288-1492

Notice:

Remove all protective plastic before assembling the chair.
Make sure to assemble the chair on a clean surface.

Parts Included In Box

*No tools are required for assembly.

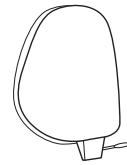

A. Backrest

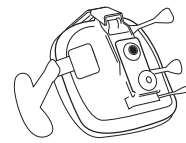

B. Seat

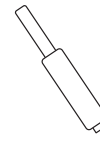

C. Pneumatic Cylinder

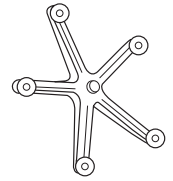

D. Base

Step 1

- 1.1 Put the seat of the chair down on a clean surface.
- 1.2 Insert pneumatic cylinder into the opening of the chair's mechanism.

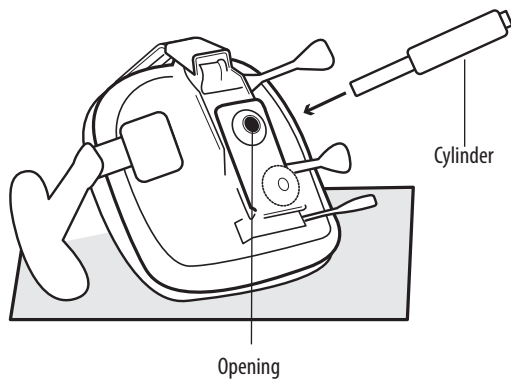

Step 2

- 2.1 Slide base on to the cylinder.
- 2.2 Turn the chair over on its casters.

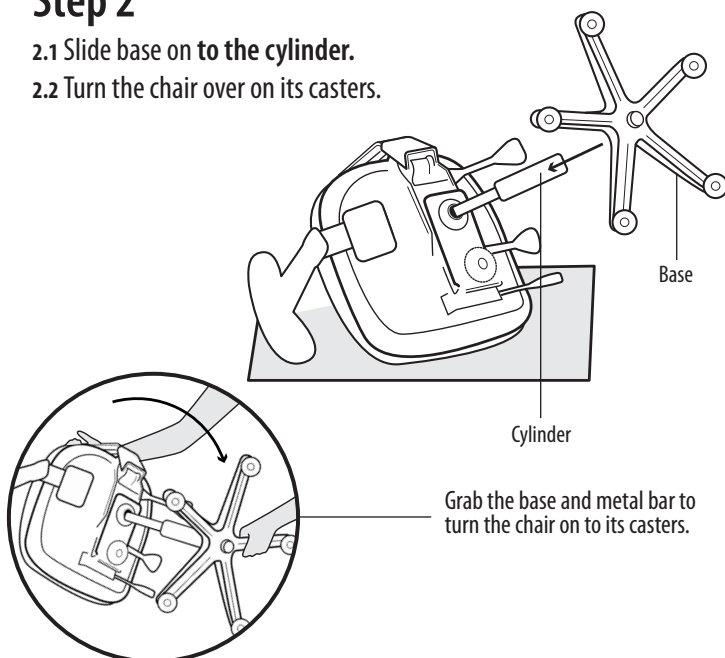

Step 3

- 3.1 While lifting the back height lever, line up the backrest and lower so the metal bar slides freely down the metal track. The height lever will lock anywhere.

